

Mold Interlock Benefits

D-M-E Side Interlocks provide:

- Accurate alignment of mold halves
- Easy installation
- Easy and cost-effective maintenance
- Industry-compatible sizes

Installation

- Install four (4) IN2 Side Interlocks per mold (one per side)
- Install IN2 Side Interlocks on the Center Line of each side of the mold
- Replace IN2 Interchangeable Inserts as desired

Precision tolerancing, precision manufacturing means off-the-shelf interchangeability

D-M-E IN2™ Mold Interlocks are manufactured to exacting standards. Precise dimensional and geometrical tolerances ensure interchangeability. Interchangeability that no one else in the industry matches — *no one*. Precision tolerancing and manufacturing ensures that all D-M-E IN2 Mold Interlock components are interchangeable — off-the-shelf. Replace any D-M-E IN2 Mold Interlock component independently — no need to replace the entire set. *No one* else offers this level of interchangeability — no one.

The D-M-E Standard of Interchangeable Interlock Components sets D-M-E apart from the industry.

And now...

D-M-E offers another innovation: **IN2 Innovative Interlocks with Interchangeable Inserts**. Interchangeable Inserts offer you simple, cost-effective maintenance. No need to replace the entire set when you use **IN2 Innovative Interlocks with Interchangeable Inserts**.



IN2 Side Interlocks

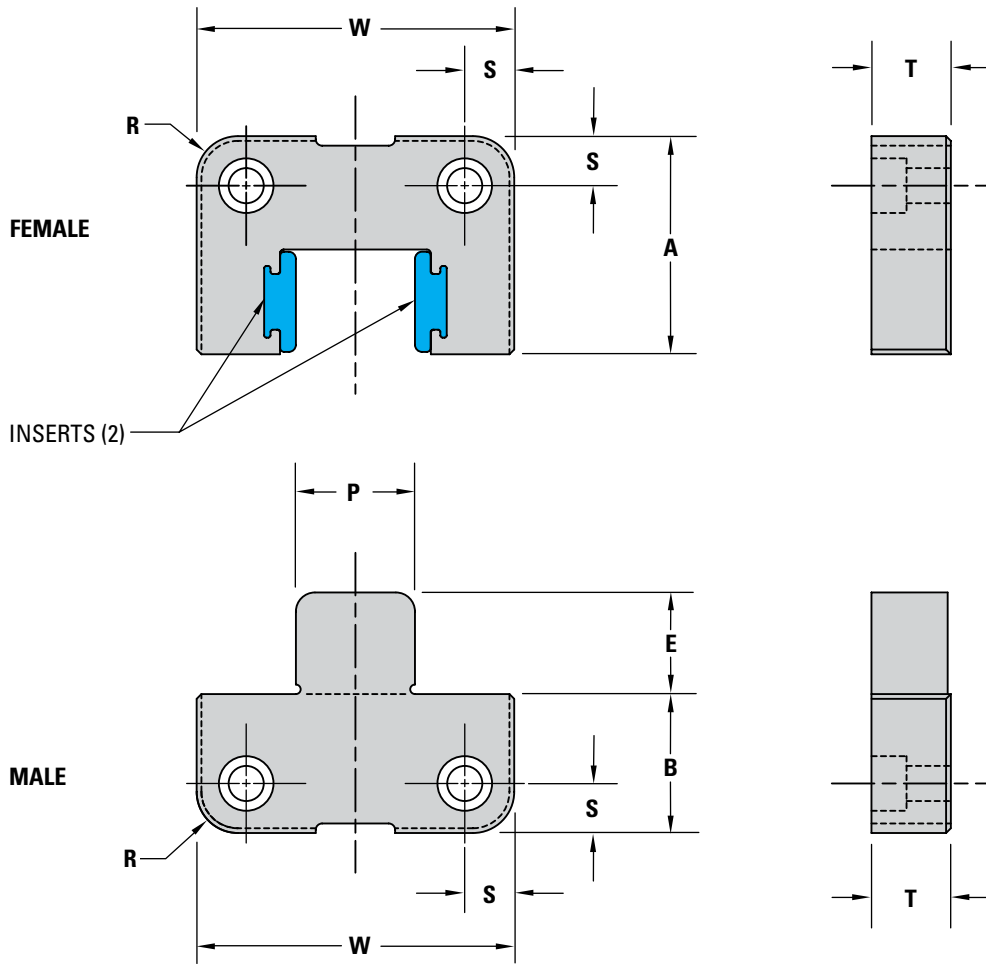

Side Interlock Dimensions

W WIDTH	A HEIGHT FEMALE	B HEIGHT MALE	E INTERLOCK HEIGHT	P INTERLOCK WIDTH	T THICKNESS	R RADII	S SCREW LOCATIONS	SHCS SIZE
1.500	.875	.875	.490	.450	.500	.26	.250	#8-32 X .62
2.000	1.375	.875	.640	.750	.500	.26	.312	#10-32 X .62
3.000	1.875	.875	.920	1.250	.750	.39	.375	1/4-20 X .88

Side Interlock Ordering Information – SIS, SII

Material – Male Interlock: High-Speed Tool Steel **Hardness:** 61-65 HRC
Material – Interlock Inserts: Graphitic Tool Steel **Hardness:** 48-52 HRC

INTERLOCK SET* ITEM NUMBER	W INTERLOCK WIDTH	REPLACEMENT INTERCHANGEABLE INSERTS** ITEM NUMBER
SIS150023	1.500	SII15003
SIS200023	2.000	SII20003
SIS300023	3.000	SII30003

*Sets include one (1) female, one (1) male, two (2) inserts, four (4) SHCS.

**Replacement Interchangeable Inserts are sold as pairs.